

G01DP Quick Release Detent Pin with Pull Ring

Features

- Quick and safe method of securing, adjusting and detaching accessories on numerous types of equipment
- Comprised of a stainless-steel shaft and two spring-loaded stainless-steel ball bearings, this quick release mechanism prevents the pin from unintentionally being removed or from working its way free due to knocks, movement and vibration
- A quick pull on the pull ring will apply sufficient force to compress the springs, and retract the ball bearings, allowing removal of the pin
- The pull ring has two functions; firstly, as simple means of pulling on the pin, and secondly as an attachment point for a lanyard or retaining chain to ensure the pin is not misplaced



Notes

- Attention must be given to the diameter of the mounting hole, the hole should be just large enough to accommodate the shaft and no larger than the diameter when the balls are extended
- The stainless-steel shaft is chamfered at one end to aid insertion

Material

- Stainless steel 304

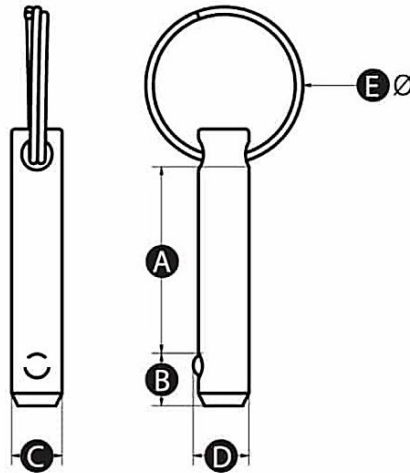

Part No.	A	B	C	D	E
G01DP-16411Q	15	7	6	6.5	25
G01DP-16412X	20				
G01DP-16413T	30				
G01DP-16414P	40				
G01DP-16415W	30	8	8	8.8	
G01DP-16416S	40				
G01DP-16417Z	50				